

9320 ROUND SHOWER VALVE - OPTION 1



PRODUCT SPECIFICATION

| | |
|---------------------|---|
| Product Code: | 9320 |
| Finish: | Chrome |
| Product Type: | Exposed wall mounting shower |
| Cartridge Type: | Thermostatic cartridge and ceramic flow cartridge |
| Inlet Connections: | 3/4 BSP |
| Outlet Connections: | 1/2 BSP |
| Fitting Dimensions: | 150mm inlet centres |
| Construction: | Body: Brass Handles: ABS |
| Gross Weight (kg): | 1.46 |



ADDITIONAL INFORMATION

- Dual Control – flow and temperature are controlled separately giving accurate control of both.
- Thermostatic cartridge maintains showering temperature to +/- 1c giving a stable outlet temperature.
- Automatic shut-off in the event of cold water supply failure, to prevent scalding.
- Temperature factory set to a 38c
- Lifetime guarantee

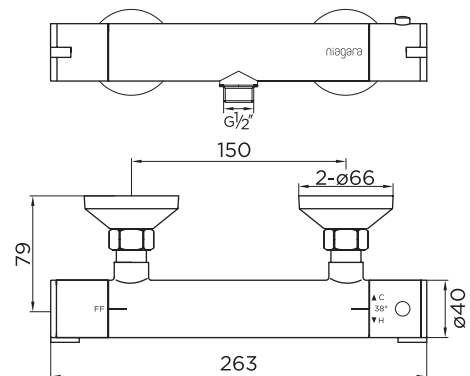

WORKING PRESSURES (bar)

| Min Pressure | Max Pressure | Best Performance |
|--------------|--------------|------------------|
| 0.5 | 10 | 3 |

FLOW RATES (litres per minute)

| 0.5 Bar | 1 Bar | 3 Bar |
|---------|-------|-------|
| 8.5 | 12 | 22 |

niagara